

J6 allows pattern recognition command of Steeper Espire Hybrid electric lock with optional pronation/supination of powered wrists and pattern recognition command of multifunction grips for various* hands. (*consult the Coapt Compatibility Guide)

PART 1: PHYSICAL CONNECTIONS

PRE-ASSEMBLED

The Coapt controller (white PCB) will be pre-attached to the Espire unit. Do NOT attempt to remove it.

PRE-ASSEMBLED CONNECTION

The Coapt **Calibrate** button is attached to the Coapt controller with its flex cable passing through the Espire Strain Relief Disc. Contact Coapt support for assistance detaching /attaching this cable from the elbow.

PRE-ASSEMBLED CONNECTION

Ensure the 2-pin, white Coapt aux connection is attached

EMG CONNECTION

The Coapt EMG Interface Cable for Espire has a special 90° exit. Ensure it is connected and secured once the Espire Strain Relief Disc is in place.

STEEPER ESPIRE HYBRID & MULTIFUNCTION HAND

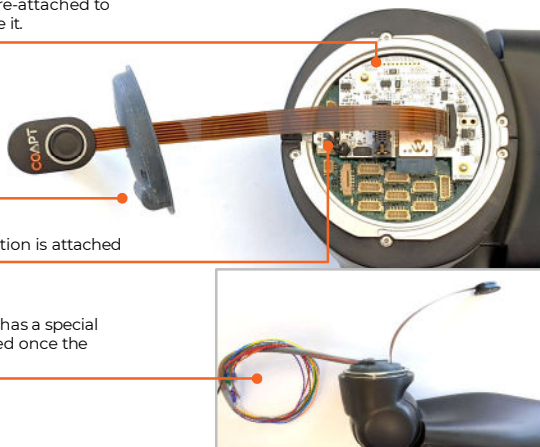

DISTAL CONNECTIONS

HANDS: TASKA, ZEUS, PSYONIC, MIA, ESPER, COVVI*, BEBIONIC (old gen)

WRIST: Fillauer Standard Wrist Rotator (5010045, 5010054, 5010055) with 6-Band Coaxial Plug (5010869)

COLOR	OUTPUT
(Orange)	Hand Open
(Green)	Hand Close
(Gray)	Rotation
(Red)	Power
(Blue)	(Not Used)
(Purple)	Digital

HANDS: I-LIMB QUANTUM

WRIST: Fillauer Standard Wrist Rotator (5010045, 5010054, 5010055) or Ottobock Electric Wrist Rotator (0517)

COLOR	OUTPUT
(Orange)	(Not Used)
(Green)	(Not Used)
(Gray)	Rotation
(Red)	Power
(Blue)	(Not Used)
(Orange)	Open/Digital
(Green)	Close/Digital

HANDS: VINCENTEVOLUTION4

WRIST: Fillauer Standard Wrist Rotator (5010045, 5010054, 5010055) or Ottobock Electric Wrist Rotator (0517)

COLOR	OUTPUT
(Orange)	(Not Used)
(Green)	(Not Used)
(Gray)	Rotation
(Red)	Power
(Blue)	(Not Used)
(Brown)	Open/Digital
(Yellow)	Close/Digital

PART 2: SOFTWARE SETTINGS

ELBOW

STEEPER ESPIRE HYBRID

In the Espire iOS user application, most screens will indicate the direct Coapt connection and not require specific settings.

WRISTS

OTTOBOCK ELECTRIC WRIST ROTATOR (NO MYOROTRONIC), FILLAUER MOTOR DIRECT WRIST ROTATOR, FILLAUER MOTOR DIRECT WRIST ROTATOR & 6-BAND COAXIAL PLUG (NO PROCONTROL)

No settings required

HANDS

I-LIMB QUANTUM (serial numbers M9618 or newer)

Ensure hand settings are the factory defaults. For proper operation of Gesture Control via Coapt, ensure 'HO' is selected as the i-mo trigger in the i-Limb app

ZEUS HAND

Input Option: Coapt, Speed Control Strategy: Proportional

TASKA

Settings will automatically be set upon each power-on. Use the QR code for more information in the Taska|Coapt Clinician Guide.



HANDS (CONT.)

COVVI HAND

Ensure all "Triggers" in the Grip Switch Trigger settings in the COVVI Go app are set to "Trigger Off"

Ensure all other hand settings in the COVVI Go app are set to the factory defaults



PSYONIC ABILITY HAND

Ensure the "Control System" setting in the PSYONIC ABILITY HAND app is set to "Coapt".

Ensure all other hand settings in the PSYONIC ABILITY HAND are set to factory defaults.

MIA HAND

Settings will automatically be set upon each power-on

VINCENTEVOLUTION4

Contact Coapt

OTTOBOCK (old generation) BEBIONIC

Contact Coapt

ESPER HAND

Ensure the grip settings in the Esper app are set exactly as shown

OTHER COMPATIBLE HANDS SHOULD BE SET TO FACTORY DEFAULT FOR OPTIMAL OPERATION

